

QSG-146-A

### STUFFING BOX SEAL INSTRUCTIONS

**A STUFFING BOX IS A CONTROLLED LEAKAGE DEVICE.**

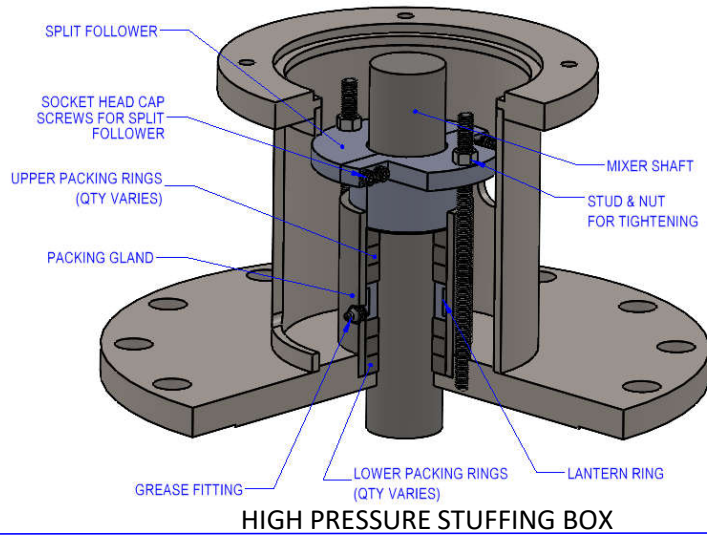

**HIGH PRESSURE STUFFING BOX**

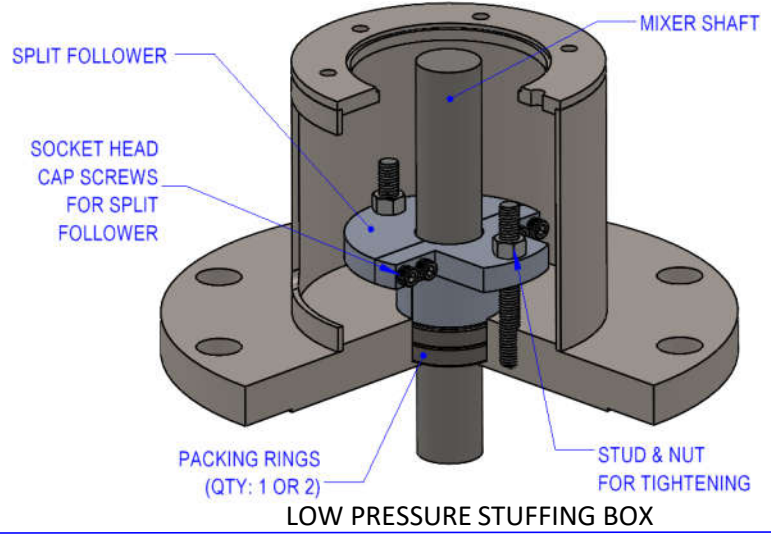

**LOW PRESSURE STUFFING BOX**

1.) THE STUFFING BOX IS FULLY ASSEMBLED AT THE TIME OF DELIVERY. THE SHAFT NEEDS TO BE INSTALLED AND THE GLAND NUTS NEED TO BE ADJUSTED BEFORE THE TANK IS FILLED.

3.) ATTACH THE SHAFT TO THE MIXER DRIVE ACCORDING TO THE APPROPRIATE QSG.

5.) TIGHTEN THE NUTS ON THE STUDS EVENLY UNTIL THERE IS RESISTANCE. **TIGHTEN**

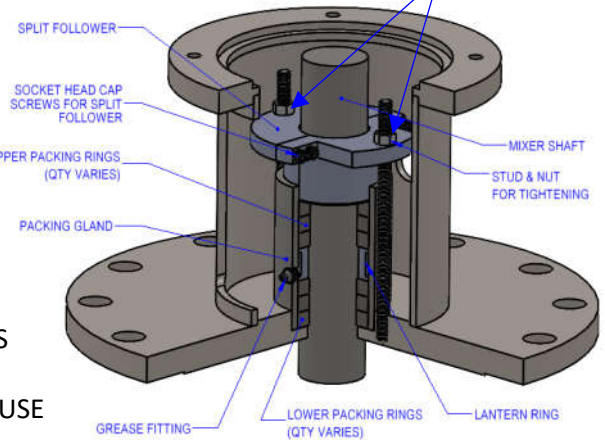
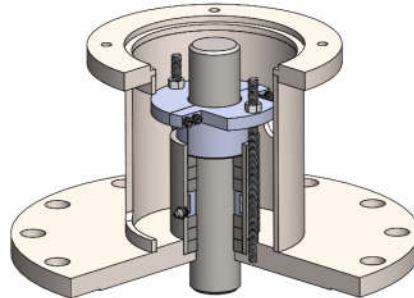
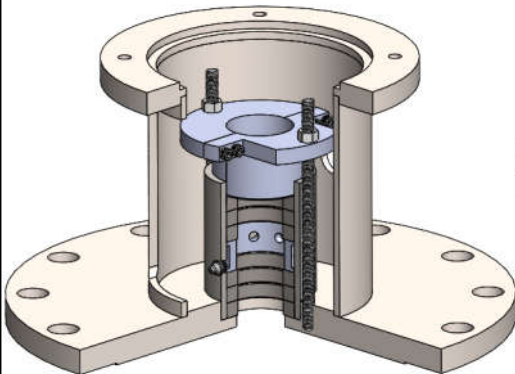

2.) SLIDE THE SHAFT UP THROUGH THE PEDESTAL BORE AND THE STUFFING BOX ASSEMBLY, TOWARDS THE MIXER DRIVE.

4.) HIGH PRESSURE STUFFING BOXES NEED TO BE LUBRICATED WITH A PROCESS COMPATIBLE LUBRICANT. USE THE GREASE FITTING TO INJECT THE GREASE INTO THE STUFFING BOX. LOW PRESSURE STUFFING BOXES ARE LUBRICATED WHILE ASSEMBLED AT THE FACTORY.

- **DO NOT OVER-TIGHTEN THE NUTS AS THIS WILL CAUSE DAMAGE TO THE SHAFT AND WILL CAUSE EXCESSIVE LOAD ON THE MOTOR.**
- **EXCESSIVE HEAT ON THE SHAFT IS AN INDICATION OF OVER-TIGHTENING.**
- **THE PROCESS OF ADJUSTING THE PACKING CAN TAKE SEVERAL DAYS OF RUNNING TO ENSURE CORRECT ADJUSTMENT.**

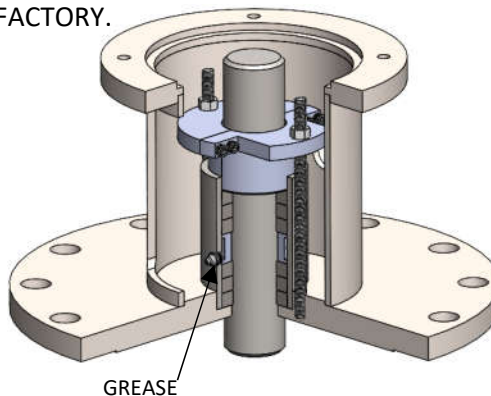
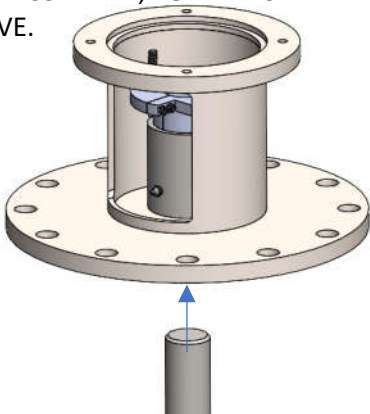

**CAUTION**  
 DISCONNECT MIXER FROM POWER SOURCE BEFORE ASSEMBLING, LIFTING, MOVING, OR SERVICING MIXER.

**CAUTION:**

- THE VISCOSITY AND SPECIFIC GRAVITY OF THE FLUID AFFECTS MIXER SIZING AND SPECIFICATIONS