

## SERIES: ALL

### HUB INSTALLATION WITH CAPTURED KEY (IF EQUIPPED)

1.) SLIDE THE IMPELLER HUB CLOSEST TO THE MIXER DRIVE ONTO THE SHAFT FIRST. SLIDE IT SO IT'S ABOVE THE SLOT FOR THE KEY, AS SHOWN. (MIXER MAY HAVE MULTIPLE IMPELLERS)

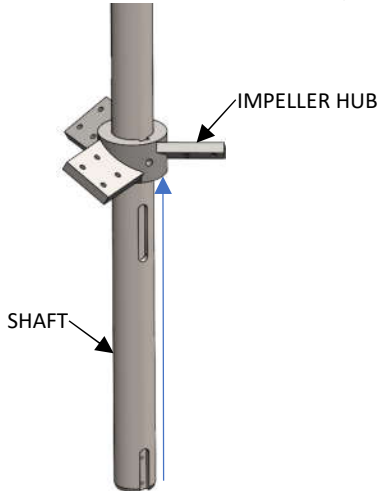

2.) INSERT THE KEY INTO THE SHAFT'S SLOT AND SLIDE THE HUB OVER THE KEY, ALIGNING THE KEYWAY IN THE HUB WITH THE KEY.

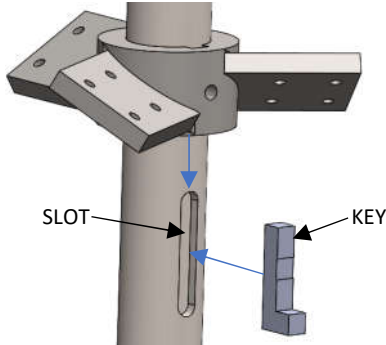

3.) TIGHTEN THE SET SCREW IN THE HUB TO THE APPROPRIATE VALUE IN THE TABLE.

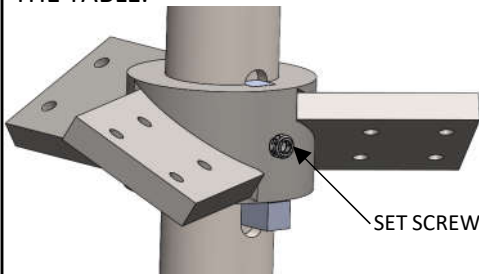

4.) IF THERE ARE MULTIPLE UPPER IMPELLERS, REPEAT THIS PROCESS FOR HOWEVER MANY THERE ARE.

### IMPELLER HUB WITH KEY INSTALLATION

#### HUB INSTALLATION WITH BOLTED KEY

1.) SLIDE THE IMPELLER HUB ONTO THE SHAFT PAST THE SLOT FOR THE KEY, AS SHOWN.

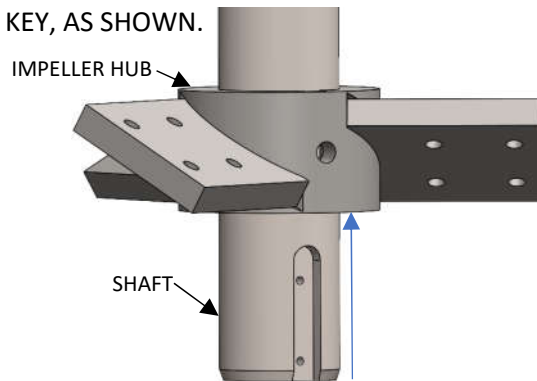

2.) INSERT THE KEY INTO THE SHAFT'S SLOT AND SECURE IT WITH THE TWO BOLTS (PROVIDED). TORQUE TO THE APPROPRIATE VALUE IN THE TABLE.

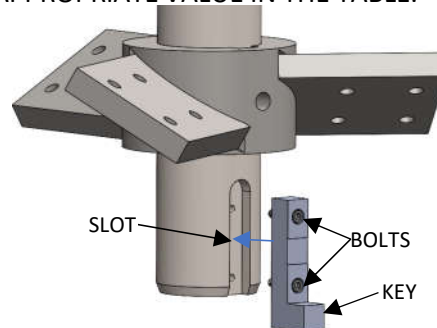

3.) SLIDE THE HUB OVER THE KEY, ALIGNING THE KEYWAY IN THE HUB WITH THE KEY.

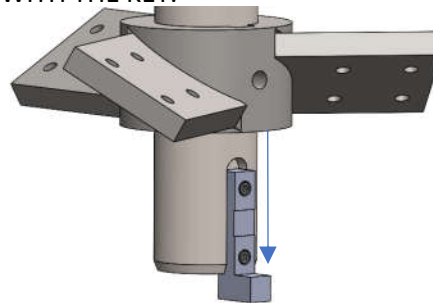

4.) TIGHTEN THE SET SCREW IN THE HUB TO THE APPROPRIATE VALUE IN THE TABLE.

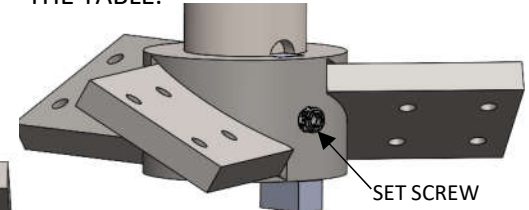

TYPICAL IMPELLER HUB CONFIGURATION SHOWN, REFER TO THE MIXER'S APPROVAL (OR AS MANUFACTURED) DRAWING FOR SPECIFICS ON YOUR MIXER'S IMPELLER CONFIGURATION.

HUB ORIENTATION IS CRITICAL. **DAMAGE IS HIGHLY LIKELY IF INSTALLED UPSIDE DOWN.**

BLADE INSTALLATION IS CRITICAL. **DAMAGE IS HIGHLY LIKELY IF INSTALLED ON THE WRONG SIDE OF THE HUB'S EAR. SEE APPROPRIATE QSG.**

BOLT SIZE	18-8 & 304 STAINLESS	316 STAINLESS
10-32	30 in-lb.	31 in-lb.
1/4-20	57 in-lb.	60 in-lb.
3/8-16	16 ft-lb.	17 ft-lb.
1/2-13	36 ft-lb.	38 ft-lb.
5/8-11	81 ft-lb.	84 ft-lb.

IMPELLER HUBS ARE SHOWN WITHOUT THE BLADES ATTACHED FOR REDUCED WEIGHT DURING INSTALLATION. IF WEIGHT IS NOT AN ISSUE, THE BLADES MAY BE ATTACHED FOR THIS PROCESS.

ONCE ALL HUB(S) ARE INSTALLED, THE BLADES CAN BE INSTALLED TO THE HUBS BY FOLLOWING THE APPROPRIATE BLADE INSTALLATION QSG.

### CAUTION

DISCONNECT MIXER FROM POWER SOURCE BEFORE ASSEMBLING, LIFTING, MOVING, OR SERVICING MIXER.

#### CAUTION:

- THE VISCOSITY AND SPECIFIC GRAVITY OF THE FLUID AFFECTS MIXER SIZING AND SPECIFICATIONS