



QSG-136-A

RT153 SINGLE SEAL SHOWN AS RECEIVED

### RT153 SINGLE SEAL INSTALLATION

LINK TO HOW TO VIDEOS

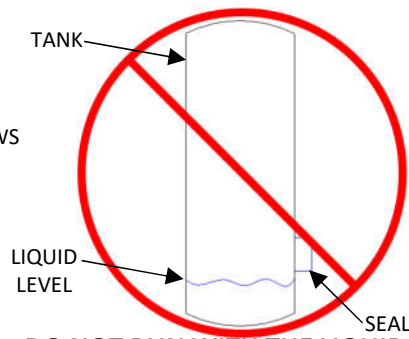
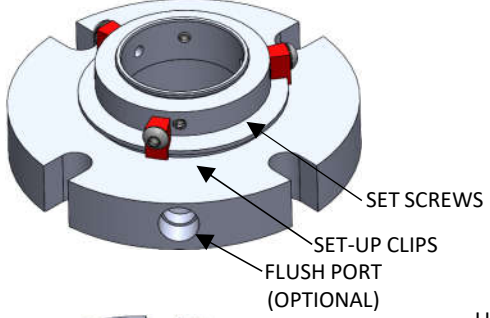

**DO NOT RUN WITH THE LIQUID LEVEL IN THE TANK BELOW THE SEAL**

5.) INSERT AND TIGHTEN THE PROVIDED 4 BOLTS IN AN ALTERNATING PATTERN TO THE APPROPRIATE VALUE IN THE TABLE.

THREAD	18-8 STAINLESS
3/8"-16	16 ft-lb.
7/16"-14	26 ft-lb.
1/2"-13	36 ft-lb.
5/8"-11	81 ft-lb.

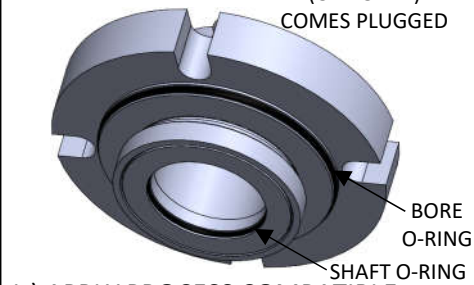
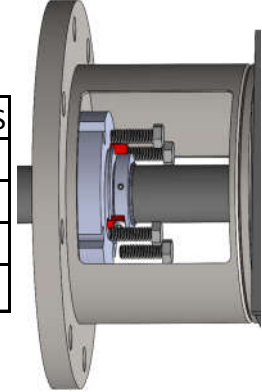

1.) APPLY PROCESS COMPATIBLE LUBRICANT TO THE SHAFT AND BORE O-RINGS, BEING CAREFUL TO ONLY PUT LUBRICANT ON THE O-RINGS. BACK OFF THE SET SCREWS SO THEY ARE CLEAR OF THE BORE.

3.) NOW THAT THE SEAL IS "FLOATED" ON THE SHAFT, ATTACH THE SHAFT TO THE MIXER DRIVE ACCORDING TO THE APPROPRIATE SHAFT INSTALLATION QSG.

6.) THREAD IN THE SET SCREWS IN AN ALTERNATING PATTERN UNTIL THEY ARE BARELY TOUCHING THE SHAFT. DO NOT TIGHTEN ONE FULLY THEN THE OTHER. ONCE ALL SET SCREWS ARE SNUG, TORQUE TO THE APPROPRIATE VALUE IN THE TABLE.

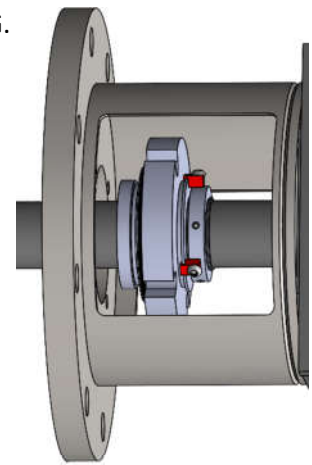
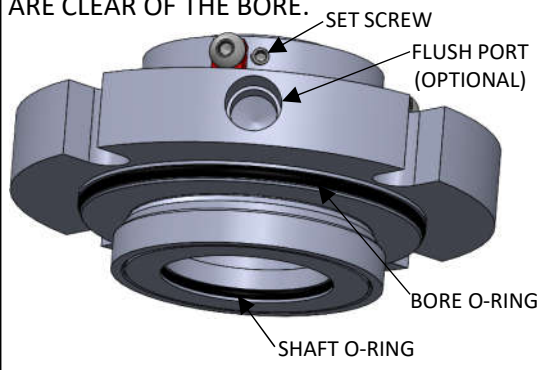

THREAD	18-8 STAINLESS
1/4"-28	72 in-lb.
5/16"-24	147 in-lb.
3/8"-24	22 ft-lb.

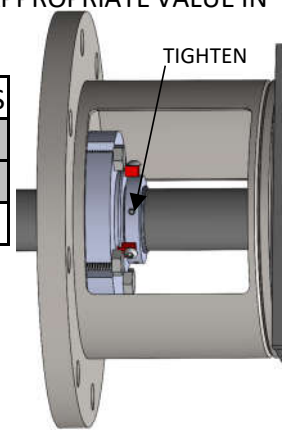

2.) INSERT THE SHAFT THROUGH THE PEDESTAL BORE AND THE SEAL BORE.

4.) SLIDE THE SEAL INTO THE PEDESTAL BORE, ALIGNING THE SLOTS IN THE SEAL TO THE TAPPED HOLES IN THE PEDESTAL. IF YOUR SEAL HAS A FLUSH PORT, ENSURE THE FLUSH PORT IS ALIGNED TO THE HOLE IN THE TOP OF THE PEDESTAL.

7.) REMOVE THE SET-UP CLIPS AND RETAIN FOR FUTURE USE. THEY WILL BE NEEDED IN THE FUTURE WHEN THE SEAL IS REMOVED.

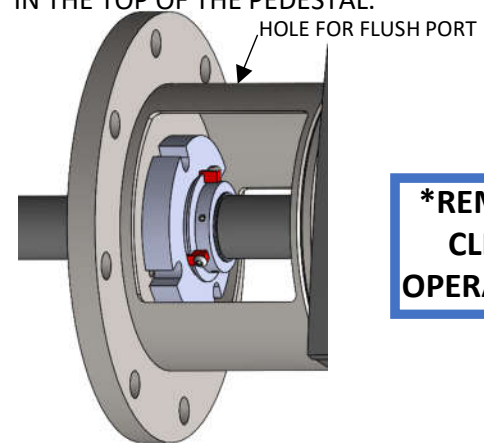
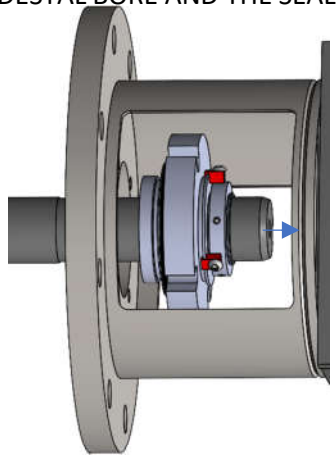

**\*REMOVE SET-UP CLIPS BEFORE OPERATING MIXER\***

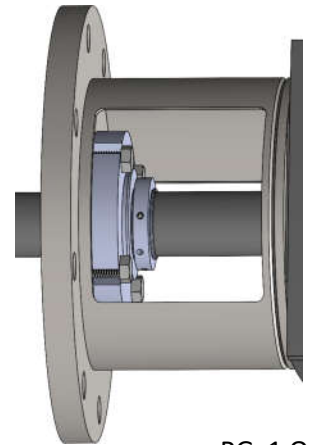

**CAUTION**  
DISCONNECT MIXER FROM POWER SOURCE BEFORE ASSEMBLING, LIFTING, MOVING, OR SERVICING MIXER.

CAUTION:

- THE VISCOSITY AND SPECIFIC GRAVITY OF THE FLUID AFFECTS MIXER SIZING AND SPECIFICATIONS
- HANDLE SEAL WITH CARE, DO NOT SET SEAL DOWN ON THE SEAL'S NON-METALLIC SURFACES

QSG-136-A

# RT153 W/ FLUSH PORT SINGLE SEAL INSTRUCTIONS

**CAUTION:**

- HANDLE SEAL WITH CARE, DO NOT SET SEAL DOWN ON THE SEAL'S NON-METALLIC SURFACES
- DO NOT RUN SEAL DRY

**FLUSH PORT** – A PORT IN THE SEAL FOR CLEAN IN PLACE TO FLOOD FLUID AROUND THE PROCESS SIDE SEAL FACE. LOW PRESSURE FLUID SHOULD BE USED WHEN FLUSHING THE FACE.

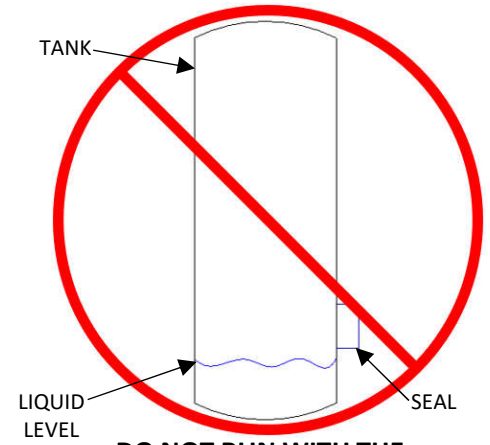
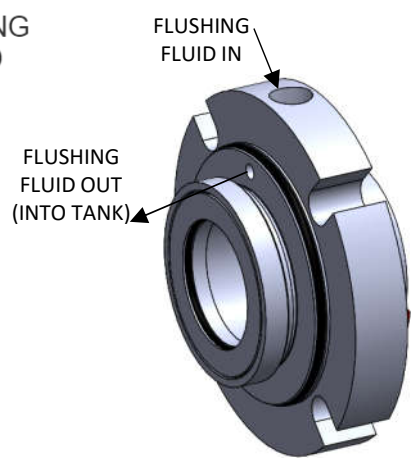
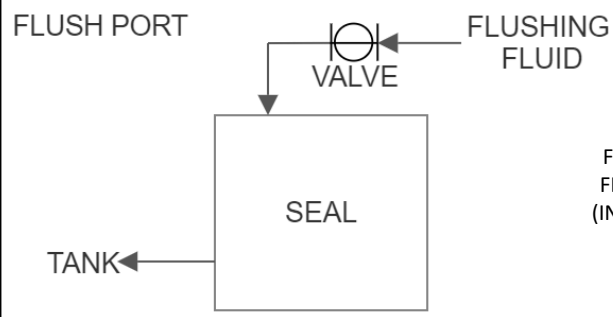

**DO NOT RUN WITH THE LIQUID LEVEL IN THE TANK BELOW THE SEAL**

IF FLUSH PORT ISN'T BEING USED IN OPERATION OR FOR CLEANING, INSTALL A PLUG. LEAVING THE FLUSH PORT OPEN WILL RESULT IN LEAKING.

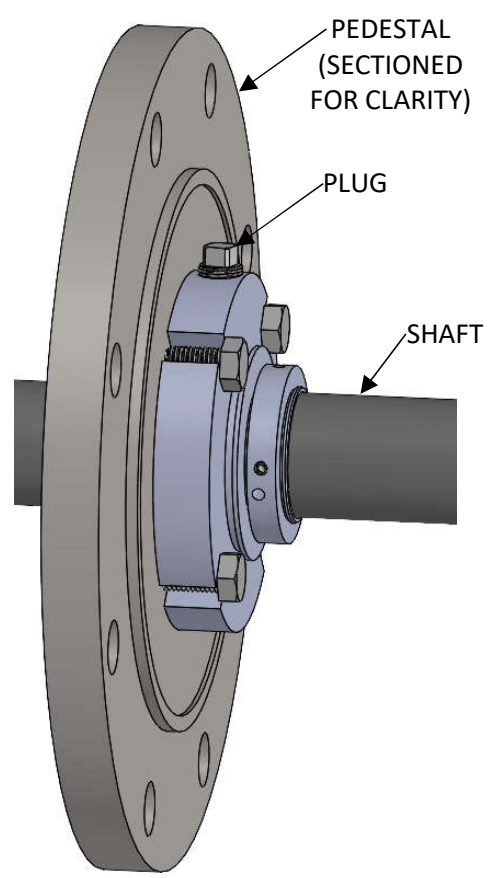

**CAUTION**  
DISCONNECT MIXER FROM POWER SOURCE BEFORE ASSEMBLING, LIFTING, MOVING, OR SERVICING MIXER.

**CAUTION:**

- THE VISCOSITY AND SPECIFIC GRAVITY OF THE FLUID AFFECTS MIXER SIZING AND SPECIFICATIONS