

QSG-121-A

BDRA SEAL INSTALLATION

BDRA SEAL IS SHOWN SEPARATED (AS RECEIVED)

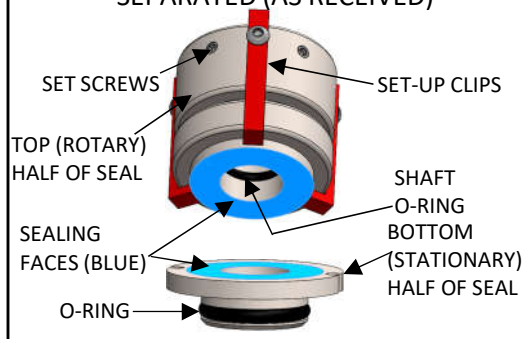

CAUTION:

- CLEAN SEAL FACES WITH AN ISOPROPYL WIPE OR CLEAN LINT FREE CLOTH
- DO NOT TOUCH SEAL FACES WITH BARE HANDS OR DIRTY GLOVED HANDS

1.) APPLY PROCESS COMPATIBLE LUBRICANT TO THE O-RING ON THE BOTTOM HALF OF THE SEAL AND THE O-RING IN THE TOP HALF OF THE SEAL, BEING CAREFUL NOT TO ALLOW ANY TO MAKE CONTACT WITH THE SEALS MATING SURFACES. BACK OFF THE SET SCREW(S) SO THEY ARE CLEAR OF THE BORE.

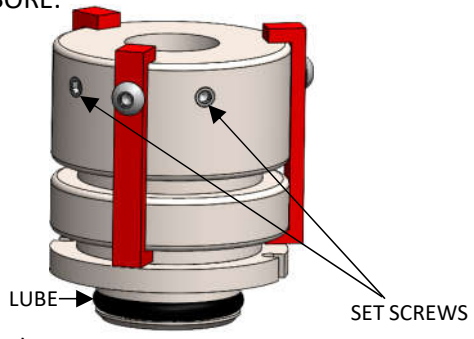

2.) SECURE BOTH HALVES OF THE SEAL TOGETHER USING TAPE OR PLASTIC WRAP, ENSURE THAT THE TAPE OR WRAP DOESN'T COME IN CONTACT WITH THE SEAL FACES AND DOESN'T COVER THE BORE. INSERT THE SHAFT THROUGH THE BOTTOM OF THE PEDESTAL AND SEAL BORE.

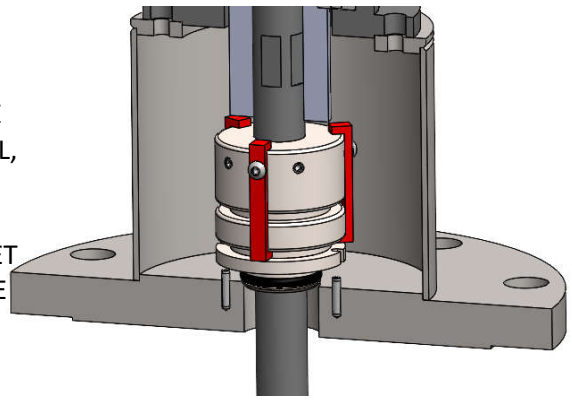

4.) REMOVE THE TAPE OR PLASTIC WRAP KEEPING THE TWO SEAL HALVES TOGETHER. SLIDE THE BOTTOM HALF OF THE SEAL DOWN THE SHAFT INTO THE BORE OF THE PEDESTAL, ALIGNING THE SLOTS IN THE SEAL TO THE PINS IN THE PEDESTAL. PRESS ON THE INNER FACE OF THE SEAL WITH A CLEAN GLOVED HAND TO DO THIS.

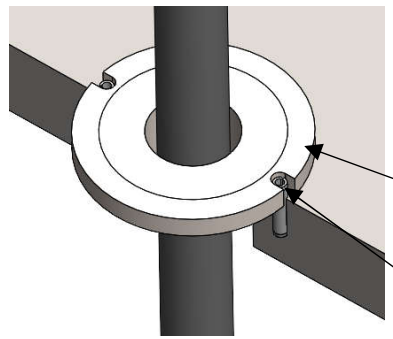

THREAD	18-8 STAINLESS
1/4"-28	72 in-lb.
5/16"-24	147 in-lb.
3/8"-24	22 ft-lb.

5.) WIPE THE SEAL FACES CLEAN WITH AN ISOPROPYL WIPE AND SLIDE THE TOP HALF OF THE SEAL DOWN THE SHAFT UNTIL THE SET-UP CLIPS ARE TOUCHING THE BOTTOM HALF.

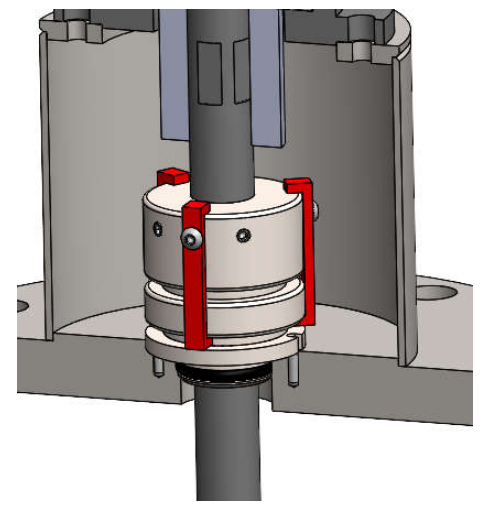

6.) THREAD IN THE SET SCREW(S) IN AN ALTERNATING PATTERN UNTIL THEY ARE BARELY TOUCHING THE SHAFT. DO NOT TIGHTEN ONE FULLY THEN THE OTHER. ONCE ALL SET SCREW(S) ARE SNUG, TORQUE TO THE APPROPRIATE VALUE IN THE TABLE.

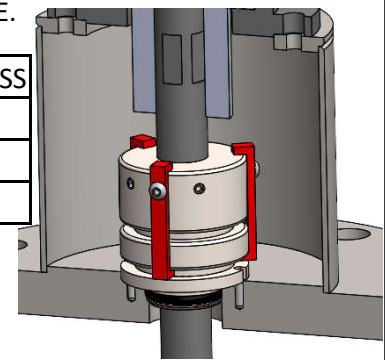

TOP OF PEDESTAL NOT SHOWN FOR ADDED CLARITY

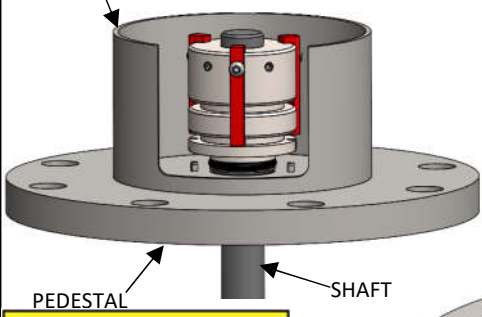

PRESS WITH A CLEAN GLOVED HAND ON INNER FACE OF SEAL OTHERWISE DAMAGE WILL OCCUR

REMOVE SET-UP CLIPS BEFORE OPERATING MIXER

7.) REMOVE THE SET-UP CLIPS AND RETAIN FOR FUTURE USE. THEY WILL BE NEEDED IN THE FUTURE WHEN THE SEAL IS REMOVED.

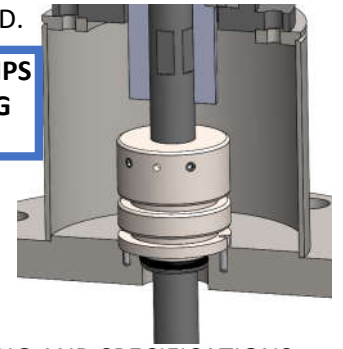

CAUTION
DISCONNECT MIXER FROM POWER SOURCE BEFORE ASSEMBLING, LIFTING, MOVING, OR SERVICING MIXER.

CAUTION:

- THE VISCOSITY AND SPECIFIC GRAVITY OF THE FLUID AFFECTS MIXER SIZING AND SPECIFICATIONS