

QSG-120-A

### CUP MOUNT INSTALLATION

DO NOT LAY MIXER ON SHAFT

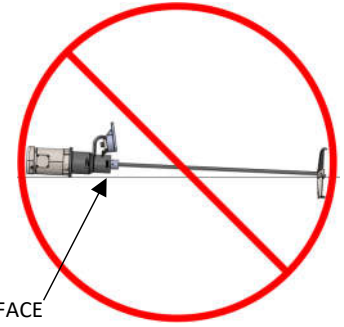
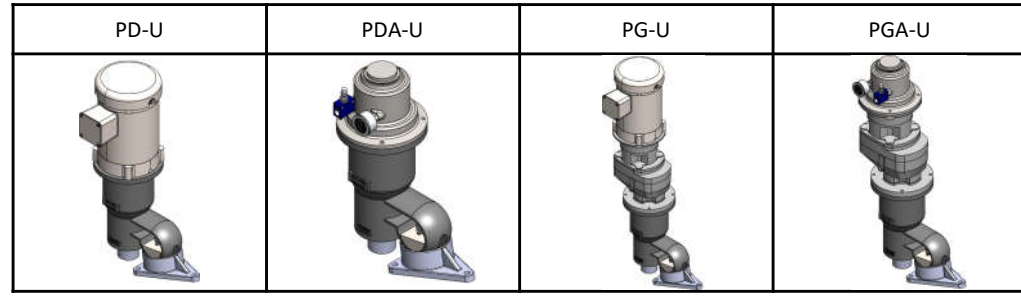

1.) REFER TO THE IMAGES BELOW FOR THE OPTIMAL MOUNTING POSITION.

2.) USE THE IMAGE BELOW FOR THE CUP PLATE MOUNTING HOLE LOCATIONS. MOUNT IS DESIGNED FOR USE WITH 3/8" BOLTS.

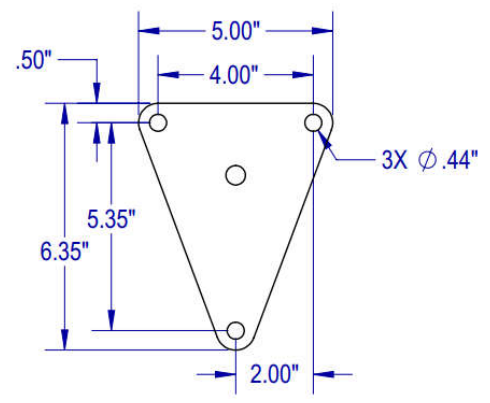
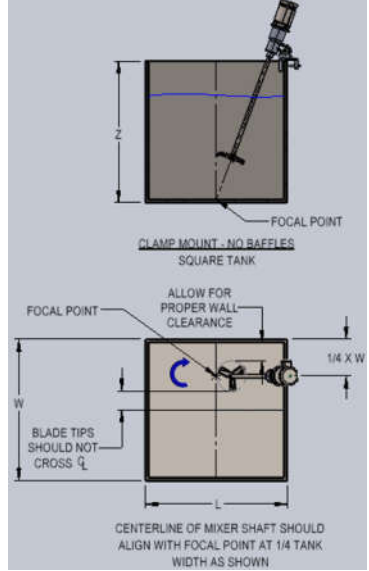
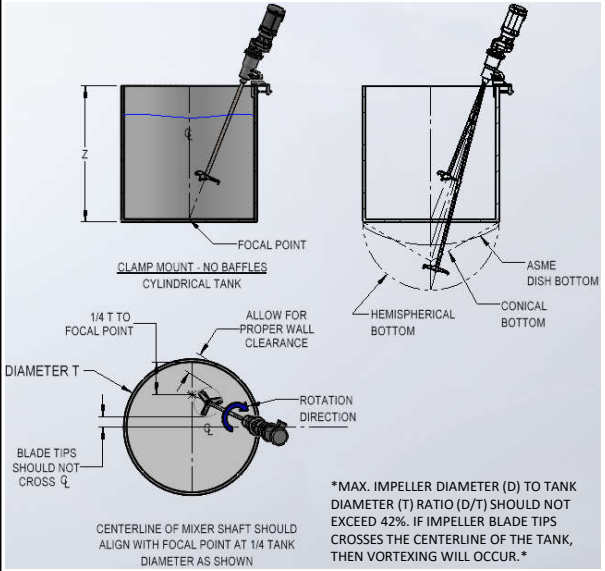

3.) MAKE SURE THE MOUNTING LOCATION WILL SUPPORT THE MIXER DURING OPERATION. IT'S RECOMMENDED TO MOUNT THE MIXER WITHOUT THE SHAFT TO AVOID DAMAGE TO THE SHAFT, IMPELLER, OR TANK. TIGHTEN THE 5/8" BOLT WITH A 15/16" WRENCH SO THE MIXER DRIVE IS SECURE TO THE CUP MOUNT (EASIER TO INSTALL WHEN TIGHT).

4.) CAREFULLY LIFT THE MIXER TO THE MOUNTING LOCATION SO THE HOLES ON THE CUP PLATE MOUNT ALIGN WITH THE HOLES IN THE MOUNTING LOCATION. INSERT AND TIGHTEN THE MOUNTING HARDWARE (NOT PROVIDED BY FUSION) TO 189 IN-LB.

5.) LOOSEN THE 5/8" BOLT TO DIRECT THE BORE TOWARDS THE FOCAL POINT (REFER TO IMAGES ABOVE). ONCE THE DESIRED LOCATION IS FOUND, TIGHTEN THE 5/8" BOLT TO 92 FT-LB. INSTALL SHAFT AND IMPELLER(S) PER THE IMPELLER INSTALLATION QSG AND APPROPRIATE SHAFT INSTALLATION QSG.

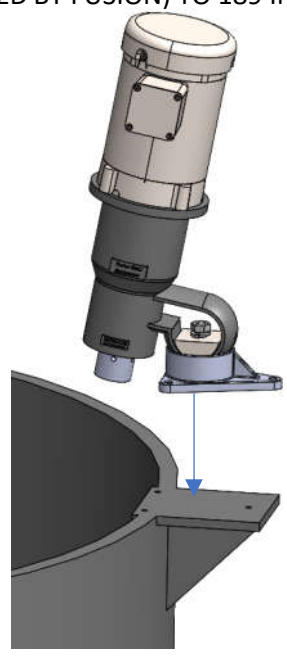
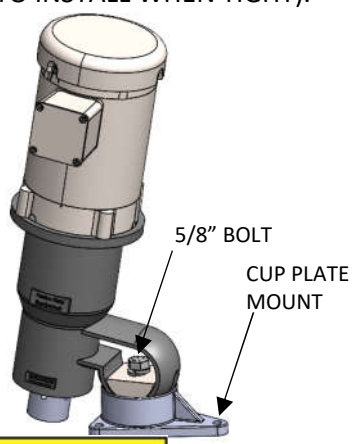

MAKE SURE THERE IS SUFFICIENT CLEARANCE BETWEEN MIXER AND TANK, ESPECIALLY WHEN RIGID COUPLINGS ARE PRESENT.

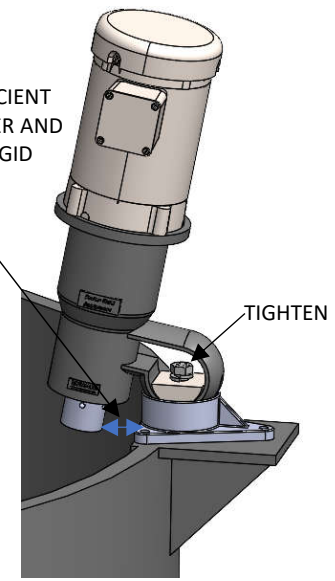

**CAUTION**  
 DISCONNECT MIXER FROM POWER SOURCE BEFORE ASSEMBLING, LIFTING, MOVING, OR SERVICING MIXER.

**CAUTION:**

- THE VISCOSITY AND SPECIFIC GRAVITY OF THE FLUID AFFECTS MIXER SIZING AND SPECIFICATIONS