

QUICK START GUIDE (QSG)

SERIES: BULK TOTE BRIDGE MOUNTING INSTRUCTIONS

QSG-106-A

[LINK TO HOW TO VIDEOS](#)

BRIDGE MOUNT HIGH SPEED LOW TORQUE ELECTRIC DRIVE	BRIDGE MOUNT HIGH SPEED LOW TORQUE AIR DRIVE	BRIDGE MOUNT LOW SPEED HIGH TORQUE ELECTRIC DRIVE	BRIDGEMOUNT LOW SPEED HIGH TORQUE AIR DRIVE

1.) ATTACH THE MIXER DRIVE TO THE BRIDGE MOUNT PLATE USING THE 4 PROVIDED 3/8 BOLTS. USE A 9/16 WRENCH AND TIGHTEN THE BOLTS TO 16 FT-LBS.

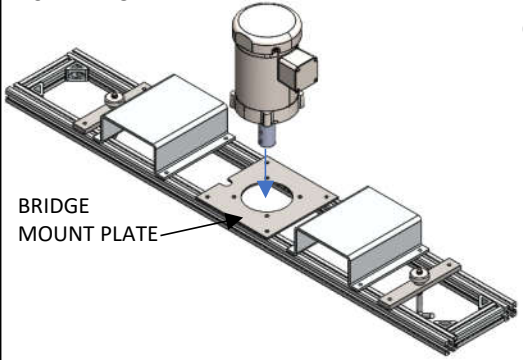

2.) REFER TO THE SHAFT INSTALLATION QSG, TO ATTACH THE SHAFT TO THE MIXER. THEN REFER TO THE IMPELLER INSTALLATION QSG TO ATTACH THE IMPELLER TO THE MIXER.

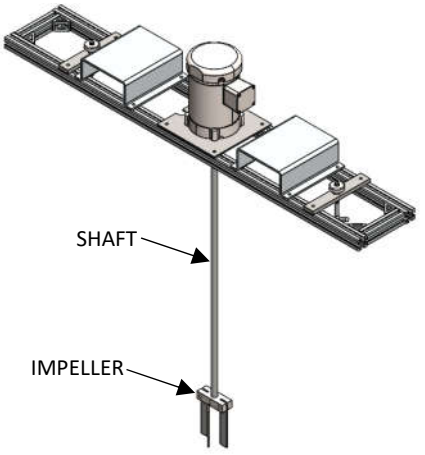

3.) LIFT THE MIXER, EITHER BY THE FORK CHANNELS (OPTIONAL) WITH A FORKLIFT OR ON THE ENDS OF THE BRIDGE MOUNT BY HAND, OVER THE TOTE AND CENTER THE SHAFT OF THE MIXER WITH THE CENTER OF THE TOTE'S HOLE.

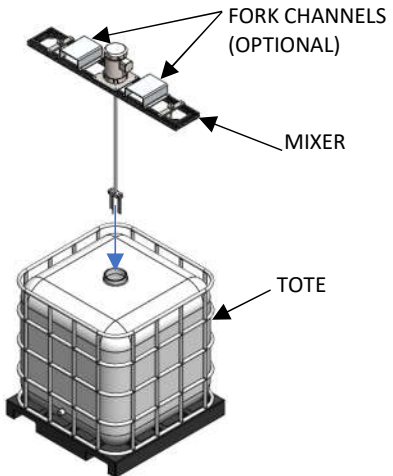

4.) CAREFULLY LOWER MIXER UNTIL BRIDGE MOUNT IS RESTING ON THE CAGE OF THE TOTE.

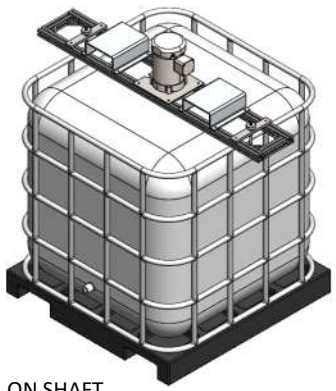

5.) LOOSEN THE TWO J-HOOK BRACKETS 5/16 BOLTS WITH A 3/16 ALLEN WRENCH. SLIDE BOTH OF THE J-HOOK BRACKETS SO THE CENTER-HOLE IS JUST ON THE INSIDE OF THE TOTE'S CAGE. TIGHTEN THE BOLTS BACK DOWN.

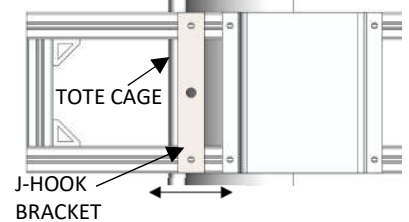

6.) INSERT THE THREADED END OF THE J-HOOK UP THROUGH THE BOTTOM OF THE CENTER HOLE OF THE J-HOOK BRACKET. THREAD ON THE KNOB AND HAND TIGHTEN, MAKING SURE THE HOOK GRABS THE TOTE CAGE. REPEAT FOR OTHER SIDE.

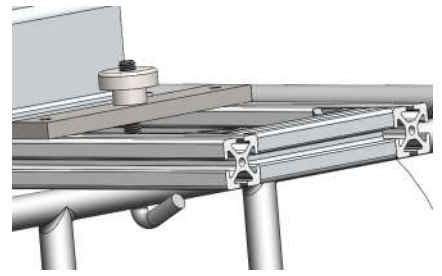

CAUTION

DISCONNECT MIXER FROM POWER SOURCE BEFORE ASSEMBLING, LIFTING, MOVING, OR SERVICING MIXER.

DO NOT LAY MIXER ON SHAFT

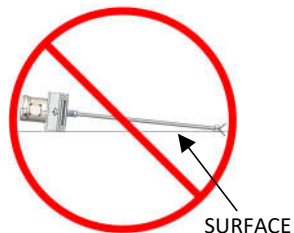

FORK CHANNELS (OPTIONAL) CAN BE ADJUSTED SIDE TO SIDE AND ARE RECOMMENDED FOR LIFTING ONLY



CAUTION:

- THE VISCOSITY AND SPECIFIC GRAVITY OF THE FLUID AFFECTS MIXER SIZING AND SPECIFICATIONS