



# QUICK START GUIDE (QSG)

## SERIES: BULK 2" NPT BUNG MOUNTING INSTRUCTIONS



2" NPT BUNG MOUNT HIGH SPEED LOW TORQUE ELECTRIC DRIVE	2" NPT BUNG MOUNT HIGH SPEED LOW TORQUE AIR DRIVE
	

DO NOT LAY MIXER ON THE SHAFT

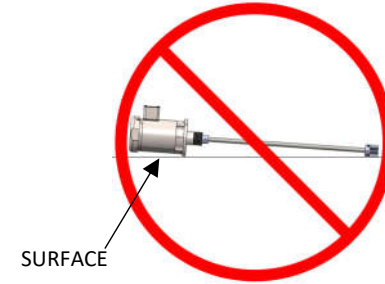

1.) REFER TO THE SHAFT INSTALLATION QSG FOR SHAFT INSTALLATION, THEN THE IMPELLER INSTALLATION QSG TO ATTACH THE IMPELLER TO THE SHAFT.

2.) REMOVE THE DRUM LID'S 2" NPT BUNG PLUG.

3.) WITH THE MIXER DISCONNECTED FROM POWER, LIFT MIXER OVER DRUM AND POSITION THE MIXER SO THE IMPELLER AND SHAFT ARE ON CENTER OF THE 2" NPT HOLE.

4.) CAREFULLY LOWER IMPELLER AND SHAFT THROUGH THE 2" NPT HOLE, UNTIL THE MIXER'S NPT BUNG MOUNT CONTACTS THE DRUM'S NPT HOLE. BE CAREFUL NOT TO HIT SHAFT ON DRUM HOLE WHEN LOWERING.

5.) CAREFULLY TURN THE MIXER CLOCKWISE TO THREAD THE MIXER TO THE DRUM. TURN UNTIL TIGHT. TO REMOVE, TURN MIXER COUNTER CLOCKWISE AND LIFT MIXER UP AND OUT.

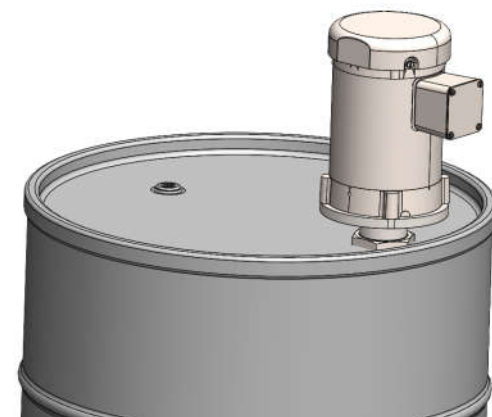
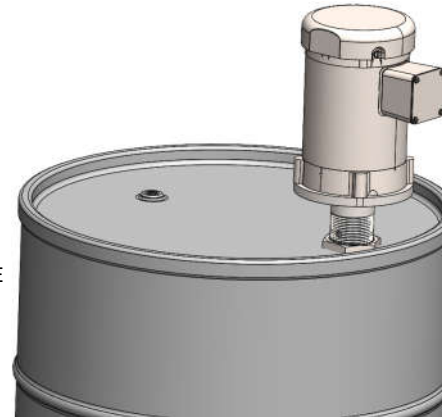
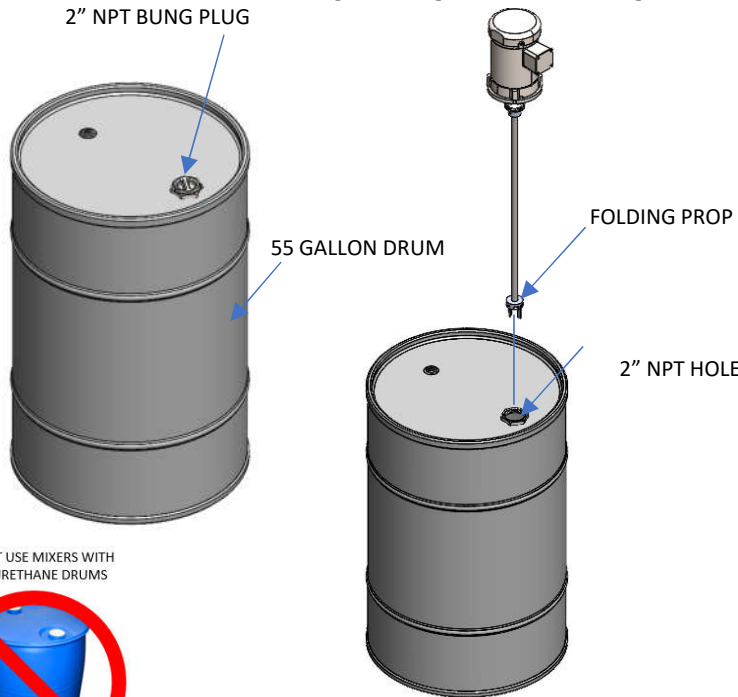

DO NOT USE MIXERS WITH POLYURETHANE DRUMS



CAUTION:

- THE VISCOSITY AND SPECIFIC GRAVITY OF THE FLUID AFFECTS MIXER SIZING AND SPECIFICATIONS

**CAUTION**

DISCONNECT MIXER FROM POWER SOURCE BEFORE ASSEMBLING, LIFTING, MOVING, OR SERVICING MIXER.

**CAUTION**

DO NOT CROSS-THREAD MIXER MOUNT AND DRUMS 2" NPT HOLE