

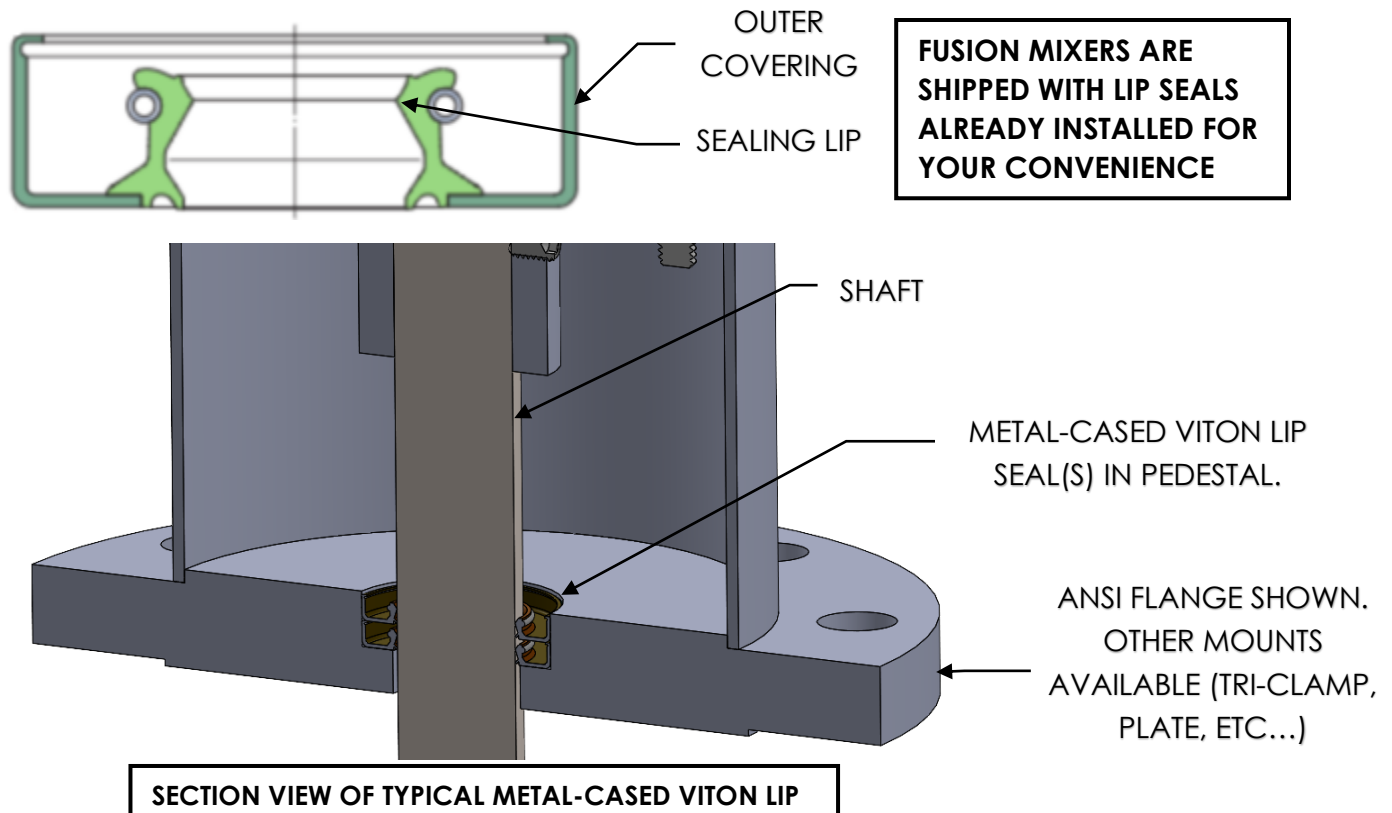

CAUTION: DISCONNECT POWER SOURCE & LOCK OUT/TAG OUT YOUR MIXER BEFORE SERVICING.
PINCH POINTS & SHARP EDGES MAY BE LOCATED IN THIS AREA.

Viton Lip Seal Overview

Radial shaft seals (Lip Seals) are assembled between rotating and stationary components. There are two main parts to the Lip Seal. One is a cylindrical exterior covering that seals statically inside the housing bore with an interference fit. The second is a sealing lip that seals around the rotating shaft.



CAUTION: DISCONNECT POWER SOURCE & LOCK OUT/TAG OUT YOUR MIXER BEFORE SERVICING.
PINCH POINTS & SHARP EDGES MAY BE LOCATED IN THIS AREA.

Shaft Installation

The lip seal(s) is typically installed at the factory in the mixer's pedestal base as shown above. If seal is not present, go to the Metal-Cased Viton Lip Seal Replacement section – step C for installation instructions. Make sure the sealing lip(s) is lubricated using process-compatible lubricant.

- A) To install the shaft, slide the shaft up through the bottom of the pedestal and the lip seal(s).

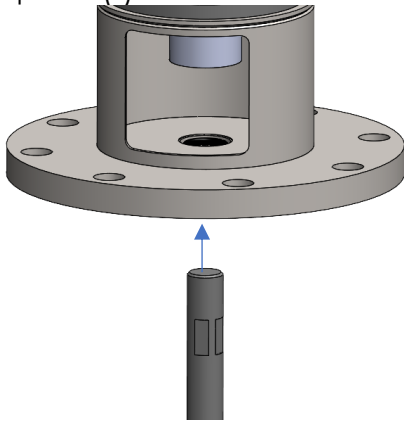

CHECK FOR SHARP EDGES OR BURRS ON SHAFT BEFORE INSERTING THROUGH LIP SEAL. DEBURR AS NECESSARY TO PREVENT CUTTING OR TEARING LIP SEAL.

- B) Attach the shaft to the mixer drive by following the appropriate manual section for your mixer.



CAUTION: DISCONNECT POWER SOURCE & LOCK OUT/TAG OUT YOUR MIXER BEFORE SERVICING. PINCH POINTS & SHARP EDGES MAY BE LOCATED IN THIS AREA.

Metal-Cased Viton Lip Seal Replacement

This section covers the replacement of the lip seal(s).

- A) Detach the shaft from the mixer drive and remove it by pulling through the lip seal and pedestal bore.

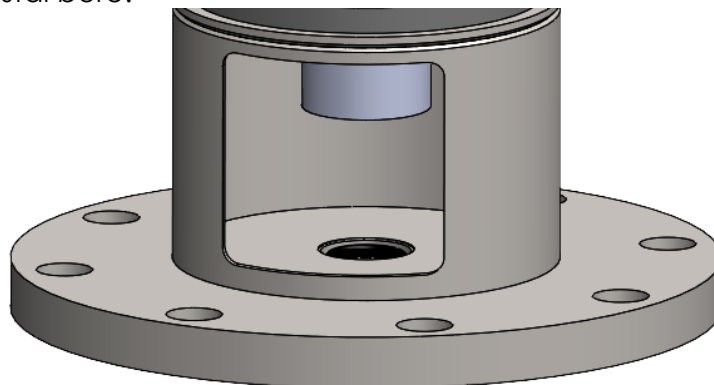

- B) Remove the existing lip seal(s) from the pedestal bore by either tapping them out from the bottom of the pedestal or pry them out from the pedestal window.

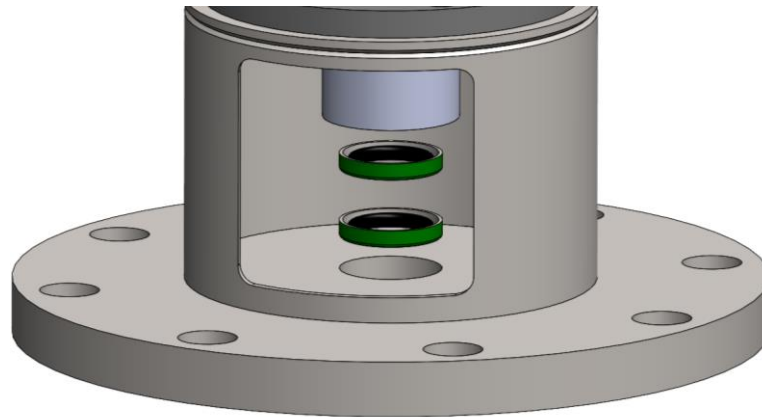

- C) Apply a light coat of process-compatible lubricant to the sealing lip of the new lip seal and the pedestal bore.

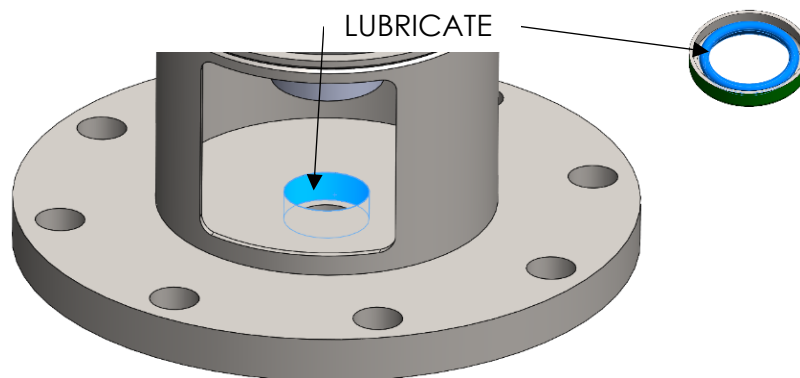

- D) Press the seal in by using a tool like the one shown below and a dead blow hammer. Make sure the seal is going into the bore square.

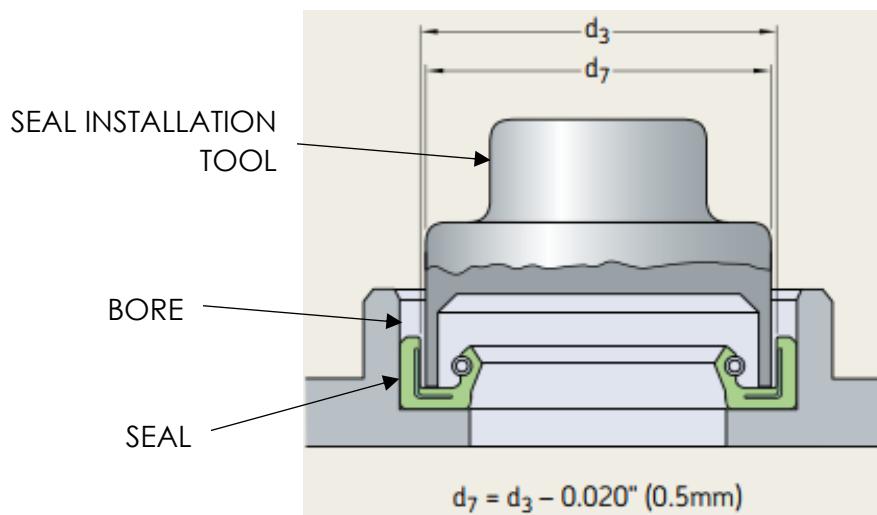

- E) If you are unable to get or make a tool like the one in the previous step, use a wooden block that's long enough to span the outside diameter of the seal and a dead blow hammer. Make sure to tap the seal into the bore following the pattern in the image to avoid tilting or skewing the seal in the bore.

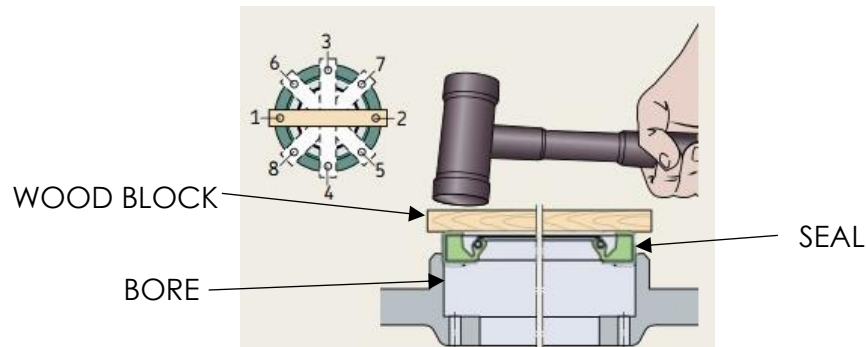

- F) Use a shorter piece of wood and this pattern to drive the seal fully into the bore. Make sure to tap the seal into the bore following the pattern in the image.

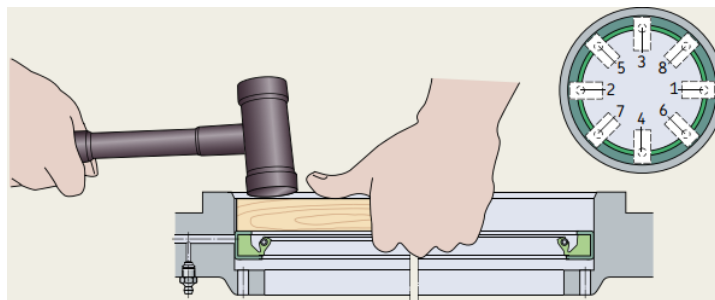

- G) Install the shaft following the instructions on Page 1.

Polymer Lip Seal with Outer O-ring Overview

A Polymer Lip Seal is a type of radial shaft seal which is assembled between rotating and stationary components. There are two main parts to the Polymer Lip Seal. One is an O-ring to create an interference fit between the seal and bore. The second is a sealing lip that seals around the rotating shaft. The Polymer Lip Seal is held in the bore with a retaining or snap ring.

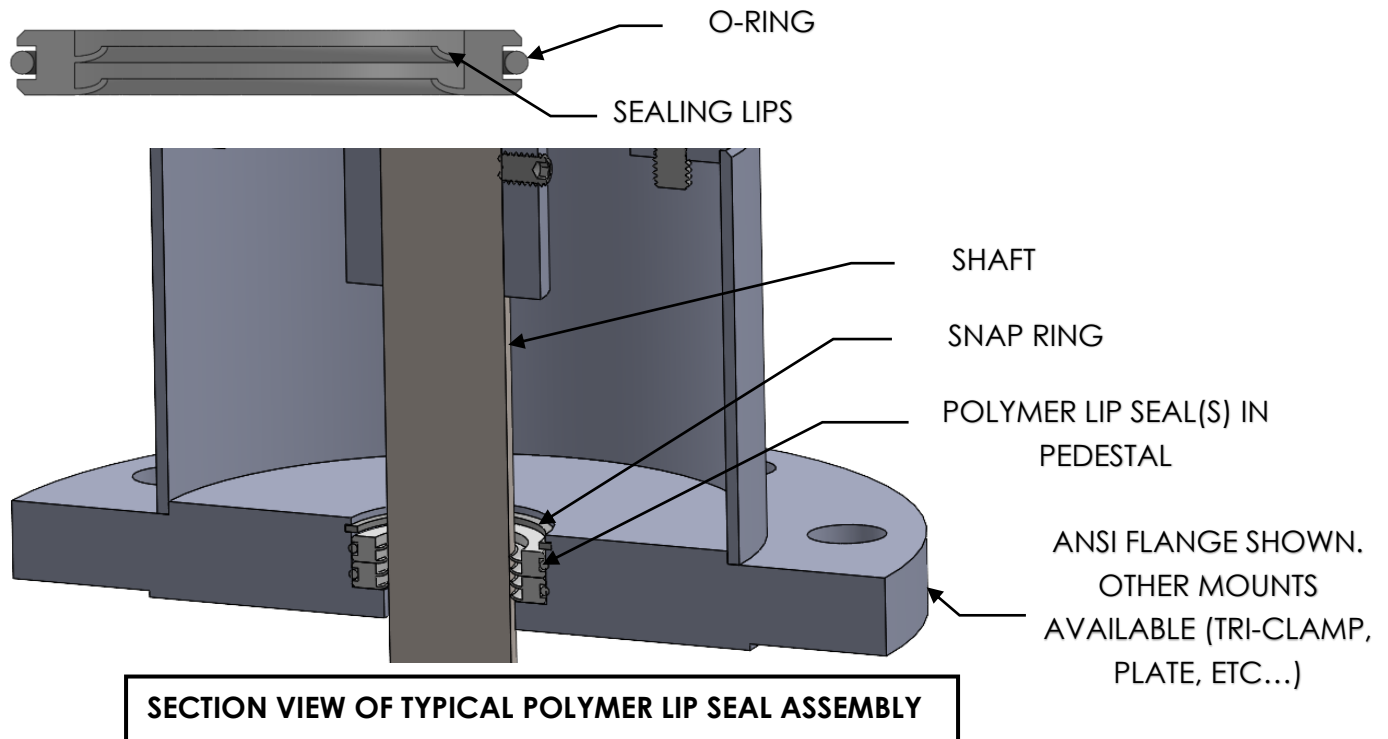

CAUTION: DISCONNECT POWER SOURCE & LOCK OUT/TAG OUT YOUR MIXER BEFORE SERVICING. PINCH POINTS & SHARP EDGES MAY BE LOCATED IN THIS AREA.

Shaft Installation

The lip seal(s) is installed in the mixer's pedestal base as shown above – same as page 1. Make sure the sealing lip(s) is lubricated using process compatible lubricant.

- A) To install the shaft, slide the shaft up through the bottom of the pedestal and the lip seal(s).

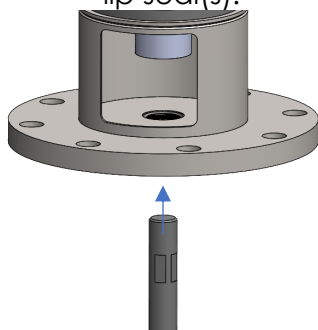

CHECK FOR SHARP EDGES OR BURRS ON SHAFT BEFORE INSERTING THROUGH LIP SEAL. DEBURR AS NECESSARY TO PREVENT CUTTING OR TEARING LIP SEAL.

- B) Attach the shaft to the mixer drive by following the appropriate manual section for your mixer.



**CAUTION: DISCONNECT POWER SOURCE & LOCK OUT/TAG OUT YOUR MIXER BEFORE SERVICING.
PINCH POINTS & SHARP EDGES MAY BE LOCATED IN THIS AREA.**

Polymer Lip Seal with Outer O-ring Replacement

This section covers the replacement of the lip seal(s).

- A) Detach the shaft from the mixer drive and remove it by pulling through the lip seal and pedestal bore.

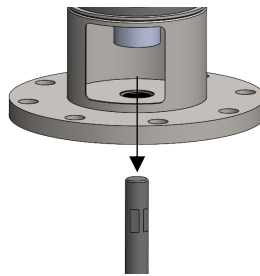

- B) Using snap ring pliers, remove the snap ring from the groove in the pedestal. Keep for re-installation.

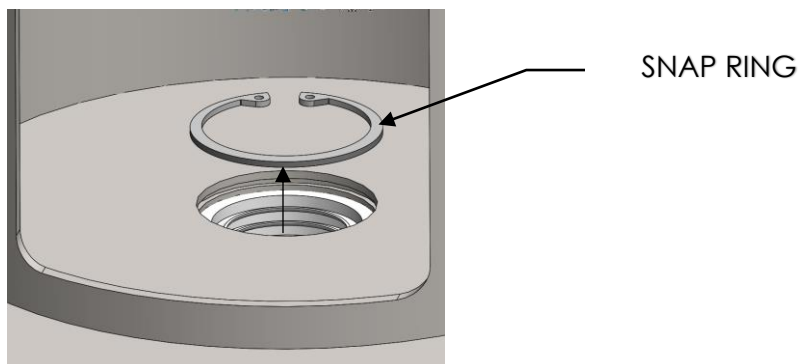

- C) Remove the existing lip seal(s) from the pedestal bore.

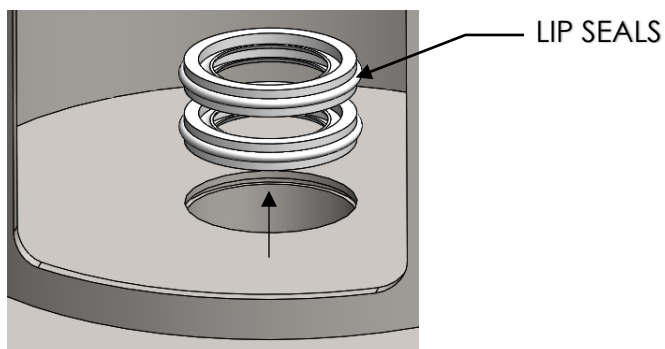

- D) Press the new lip seal(s) into the pedestal bore. Note the orientation shown below, the lip should curve up.

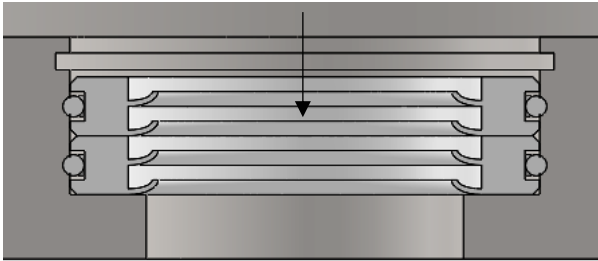

**TYPICALLY, THE LIP SEALS ARE
INSTALLED WITH THE LIP CURVE UP.
NOT ALL LIP SEALS HAVE 2 LIPS.**

- E) Re-install the snap ring with snap ring pliers, making sure it's fully seated in the snap ring groove.

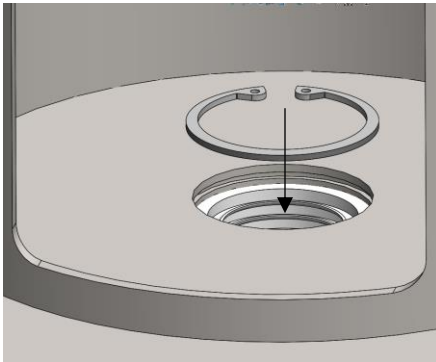

- F) Install the shaft following the instructions on page 4. Attach the shaft to the mixer drive by following the appropriate manual section for your mixer.